

NOTE: BREAK ALL CORNERS WITH 0.015" (0.38 MM) RADIUS UNLESS OTHERWISE NOTED. STANDARD TOLERANCES TO APPLY UNLESS OTHERWISE SPECIFIED.

CUSTOMER PART No.	CUSTOMER WOLVERINE STD	WLV DIE No. WH11046	REV No. 0
DESCRIPTION 5" O.D. x .188" WALL TUBE		QUOTE No. 21-1456-3	PROPOSAL No. H-15326

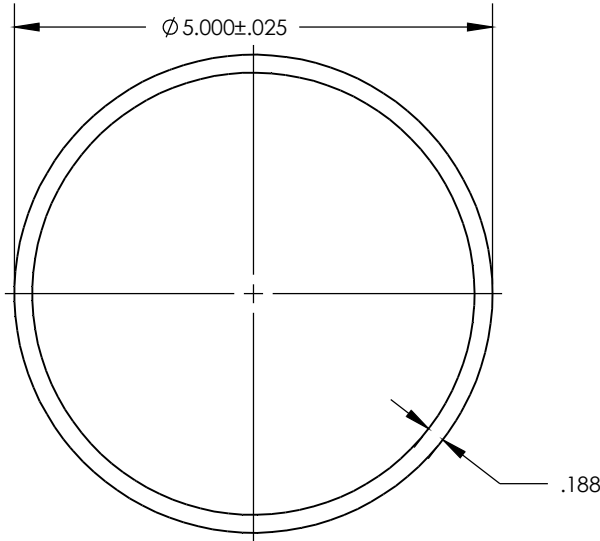

WALL THICKNESS .188

DATE	REV	DESCRIPTION		BY
EST. AREA	2.842	IN. ²	EST. AREA 1833.545	MM. ²
EST. WT.	3.327	LBS/FT.	EST. WT. 4.951	KG/M
EST. PER.	30.235	IN.	EST. PER. 767.969	MM.
OUT PER.	15.708	IN.	OUT PER. 398.983	MM.
C.C.D.	5.000	IN.	C.C.D. 127.000	MM.
FACTOR 9	FINISH M/F	ALLOY & TEMP. 6061/6063		
CKD BY	SCALE 1:2	DWN BY B.A.	DATE 6/21/21	

WOLVERINE

2100 MARKET STREET
DECATUR, AL 35816
800-633-3972

THIS DRAWING IS NOT NECESSARILY A COPY OF YOUR ORIGINAL. PLEASE APPROVE DIMENSIONS AND TOLERANCES INDICATED. WOLVERINE ASSUMES NO RESPONSIBILITY EITHER TECHNICAL OR LEGAL FOR HAVING THIS SHAPE MADE. THE CUSTOMER AGREES TO FULLY PROTECT WOLVERINE FROM CLAIMS OF OTHERS RESULTING FROM THIS SHAPE.

SIGNED: _____ DATE: _____
PRINT NAME: _____