

NOTE: BREAK ALL CORNERS WITH 0.015" (0.38 MM) RADIUS UNLESS OTHERWISE NOTED. STANDARD TOLERANCES TO APPLY UNLESS OTHERWISE SPECIFIED.

CUSTOMER PART No.	CUSTOMER WOLVERINE STD	WLV DIE No. WS10038	REV No. 0
DESCRIPTION 2 x 1 x .125 WALL CHANNEL		QUOTE No. 17-1012-8	PROPOSAL No. S-10046

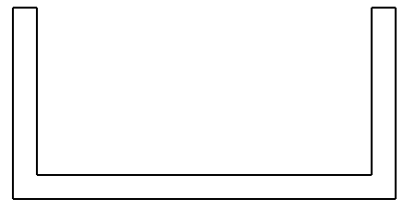
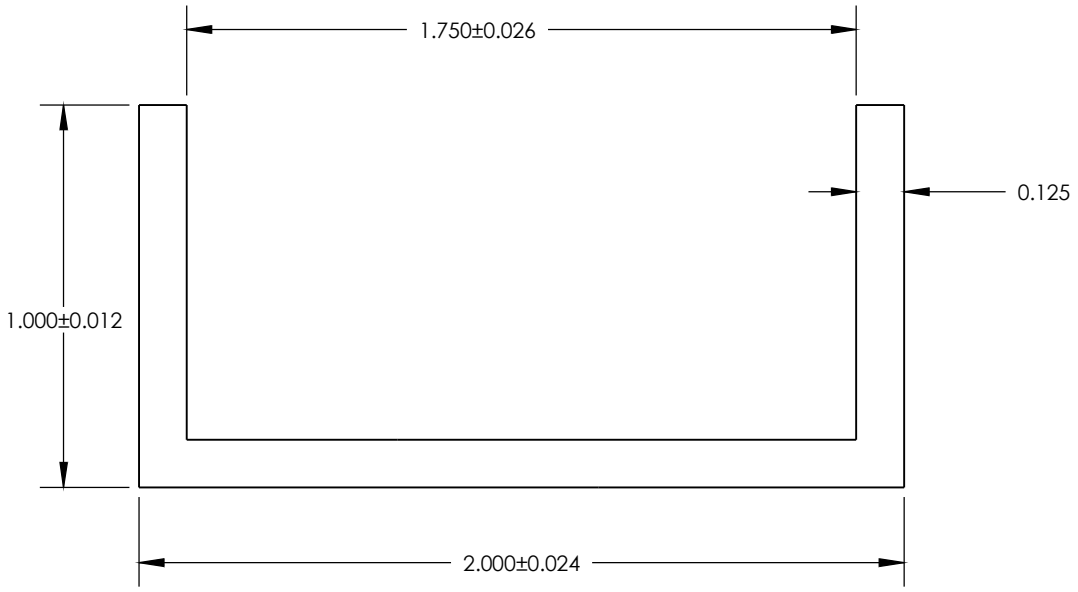

WALL THICKNESS $.125 \pm .008$ EXCEPT AS SHOWN UNSPECIFIED RADIUS .015

DATE	REV	DESCRIPTION	BY
EST. AREA	.469	IN. ²	EST. AREA 302.58
EST. WT.	.549	LBS/FT.	EST. WT. .817
EST. PER.	7.750	IN.	EST. PER. 196.85
OUT PER.		IN.	OUT PER.
C.C.D.	2.236	IN.	C.C.D. 56.794
FACTOR 14	FINISH M/F	ALLOY & TEMP.	6063-T5
CKD BY	SCALE 2:1	DWN BY B.A.	DATE 12/7/17

WOLVERINE 2100 MARKET STREET
 DECATUR, AL 35816
 800-633-3972

THIS DRAWING IS NOT NECESSARILY A COPY OF YOUR ORIGINAL. PLEASE APPROVE DIMENSIONS AND TOLERANCES INDICATED. WOLVERINE ASSUMES NO RESPONSIBILITY EITHER TECHNICAL OR LEGAL FOR HAVING THIS SHAPE MADE. THE CUSTOMER AGREES TO FULLY PROTECT WOLVERINE FROM CLAIMS OF OTHERS RESULTING FROM THIS SHAPE.

SIGNED: _____ **DATE:** _____

PRINT NAME: _____