

NOTE: BREAK ALL CORNERS WITH 0.015" (0.38 MM) RADIUS UNLESS OTHERWISE NOTED. STANDARD TOLERANCES TO APPLY UNLESS OTHERWISE SPECIFIED.

CUSTOMER PART No.	CUSTOMER WOLVERINE STD	WLV DIE No. WH10039	REV No. 0
DESCRIPTION 3 x 1 x .125 WALL TUBE	QUOTE No. 17-1012-9	PROPOSAL No. H-10047	

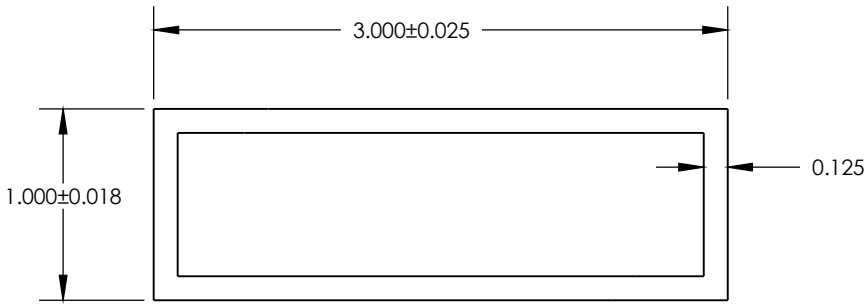

ACTUAL SIZE

UNSPECIFIED RADIUS .015

WALL THICKNESS .125 ± .008 EXCEPT AS SHOWN

DATE	REV	DESCRIPTION	BY
EST. AREA	.938	IN. ²	EST. AREA 605.16
EST. WT.	1.097	LBS/FT.	EST. WT. 1.633
EST. PER.	15.000	IN.	EST. PER. 622.96
OUT PER.	8.000	IN.	OUT PER. 203.2
C.C.D.	3.162	IN.	C.C.D. 80.315
FACTOR 14	FINISH M/F	ALLOY & TEMP.	6063-T5
CKD BY	SCALE 1:1	DWN BY B.A.	DATE 10/30/17

WOLVERINE

2100 MARKET STREET
DECATUR, AL 35816
800-633-3972

THIS DRAWING IS NOT NECESSARILY A COPY OF YOUR ORIGINAL. PLEASE APPROVE DIMENSIONS AND TOLERANCES INDICATED. WOLVERINE ASSUMES NO RESPONSIBILITY EITHER TECHNICAL OR LEGAL FOR HAVING THIS SHAPE MADE. THE CUSTOMER AGREES TO FULLY PROTECT WOLVERINE FROM CLAIMS OF OTHERS RESULTING FROM THIS SHAPE.

SIGNED: _____ **DATE:** _____

PRINT NAME: _____