

NOTE: BREAK ALL CORNERS WITH 0.015" (0.38 MM) RADIUS UNLESS OTHERWISE NOTED. STANDARD TOLERANCES TO APPLY UNLESS OTHERWISE SPECIFIED.

CUSTOMER PART No.	CUSTOMER WOLVERINE STD	WLV DIE No. WS10557	REV No. 0
DESCRIPTION 3.000 x 1.000 x .125 CHANNEL		QUOTE No. 19-1620-1	PROPOSAL No. S-12564

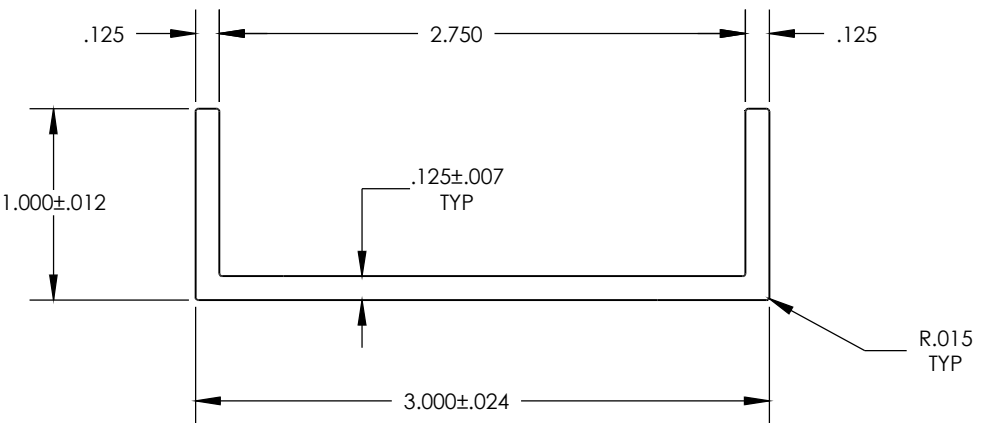

WALL THICKNESS .125 ± .007

DATE	REV	DESCRIPTION	BY
EST. AREA	.594	IN. ²	EST. AREA 383.225
EST. WT.	.695	LBS/FT.	EST. WT. 1.034
EST. PER.	9.698	IN.	EST. PER. 246.329
OUT PER.		IN.	OUT PER.
C.C.D.	3.154	IN.	C.C.D. 80.112
FACTOR 14	FINISH M/F	ALLOY & TEMP.	6063
CKD BY	SCALE 1:1	DWN BY B.A.	DATE 10/10/19

WOLVERINE 2100 MARKET STREET
 DECATUR, AL 35816
 800-633-3972

THIS DRAWING IS NOT NECESSARILY A COPY OF YOUR ORIGINAL. PLEASE APPROVE DIMENSIONS AND TOLERANCES INDICATED. WOLVERINE ASSUMES NO RESPONSIBILITY EITHER TECHNICAL OR LEGAL FOR HAVING THIS SHAPE MADE. THE CUSTOMER AGREES TO FULLY PROTECT WOLVERINE FROM CLAIMS OF OTHERS RESULTING FROM THIS SHAPE.

SIGNED: _____ DATE: _____
 PRINT NAME: _____