

NOTE: BREAK ALL CORNERS WITH 0.015" (0.38 MM) RADIUS UNLESS OTHERWISE NOTED. STANDARD TOLERANCES TO APPLY UNLESS OTHERWISE SPECIFIED.

CUSTOMER PART No.	CUSTOMER WOLVERINE STD	WLV DIE No. WS10554	REV No. 0
DESCRIPTION 3/4" x 3/4" x .125 THK. CHANNEL		QUOTE No. 19-1602-1	PROPOSAL No. S-12522

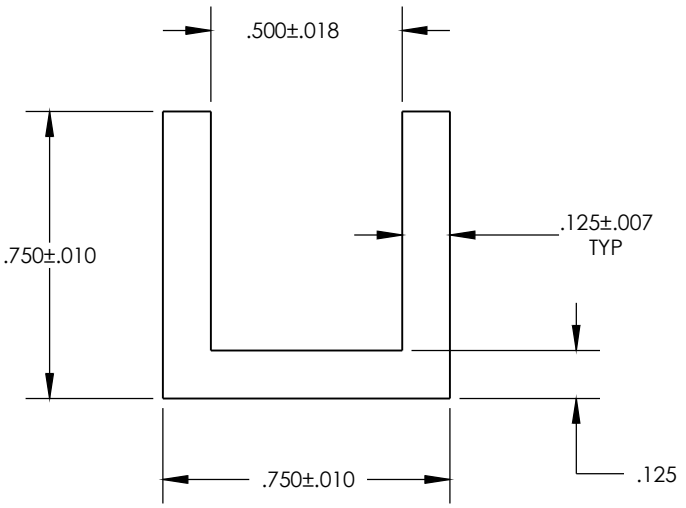

WALL THICKNESS $.125 \pm .007$

DATE	REV	DESCRIPTION	BY
EST. AREA	.250	IN. ²	EST. AREA 161.290
EST. WT.	.292	LBS/FT.	EST. WT. .435
EST. PER.	4.198	IN.	EST. PER. 106.629
OUT PER.		IN.	OUT PER.
C.C.D.	1.048	IN.	C.C.D. 26.619
FACTOR 14.5	FINISH M/F	ALLOY & TEMP. 6063	
CKD BY	SCALE 2:1	DWN BY B.A.	DATE 10/3/19

WOLVERINE 2100 MARKET STREET
DECATUR, AL 35816
800-633-3972

THIS DRAWING IS NOT NECESSARILY A COPY OF YOUR ORIGINAL. PLEASE APPROVE DIMENSIONS AND TOLERANCES INDICATED. WOLVERINE ASSUMES NO RESPONSIBILITY EITHER TECHNICAL OR LEGAL FOR HAVING THIS SHAPE MADE. THE CUSTOMER AGREES TO FULLY PROTECT WOLVERINE FROM CLAIMS OF OTHERS RESULTING FROM THIS SHAPE.

SIGNED: _____ DATE: _____
PRINT NAME: _____