

NOTE: BREAK ALL CORNERS WITH 0.015" (0.38 MM) RADIUS UNLESS OTHERWISE NOTED. STANDARD TOLERANCES TO APPLY UNLESS OTHERWISE SPECIFIED.

CUSTOMER PART No.	CUSTOMER WOLVERINE STD	WLV DIE No. WS10172	REV No. 0
DESCRIPTION 5" x 1/2" THK. FLAT BAR		QUOTE No. 18-1163-2	PROPOSAL No. S-10463

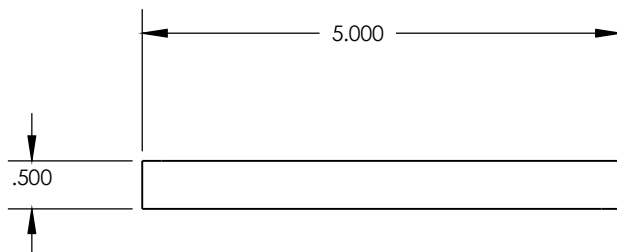

WALL THICKNESS .500 EXCEPT AS SHOWN

DATE	REV	DESCRIPTION	BY
EST. AREA	2.500	IN. ²	EST. AREA 1612.900
EST. WT.	2.926	LBS/FT.	EST. WT. 4.354
EST. PER.	11.000	IN.	EST. PER. 279.400
OUT PER.		IN.	OUT PER.
C.C.D.	5.025	IN.	C.C.D. 127.635
FACTOR 4	FINISH M/F	ALLOY & TEMP.	6061
CKD BY	SCALE 1:2	DWN BY B.A.	DATE 7/24/18

WOLVERINE

2100 MARKET STREET
DECATUR, AL 35816
800-633-3972

THIS DRAWING IS NOT NECESSARILY A COPY OF YOUR ORIGINAL. PLEASE APPROVE DIMENSIONS AND TOLERANCES INDICATED. WOLVERINE ASSUMES NO RESPONSIBILITY EITHER TECHNICAL OR LEGAL FOR HAVING THIS SHAPE MADE. THE CUSTOMER AGREES TO FULLY PROTECT WOLVERINE FROM CLAIMS OF OTHERS RESULTING FROM THIS SHAPE.

SIGNED: _____ DATE: _____

PRINT NAME: _____