

NOTE: BREAK ALL CORNERS WITH 0.015" (0.38 MM) RADIUS UNLESS OTHERWISE NOTED. STANDARD TOLERANCES TO APPLY UNLESS OTHERWISE SPECIFIED.

CUSTOMER PART No.	CUSTOMER WOLVERINE OPEN SHAPE	WLV DIE No. WS10140	REV No. 0
DESCRIPTION 3/4 x 1-1/2 x 1/8 ANGLE	QUOTE No. 18-1010-8	PROPOSAL No. S-10308	

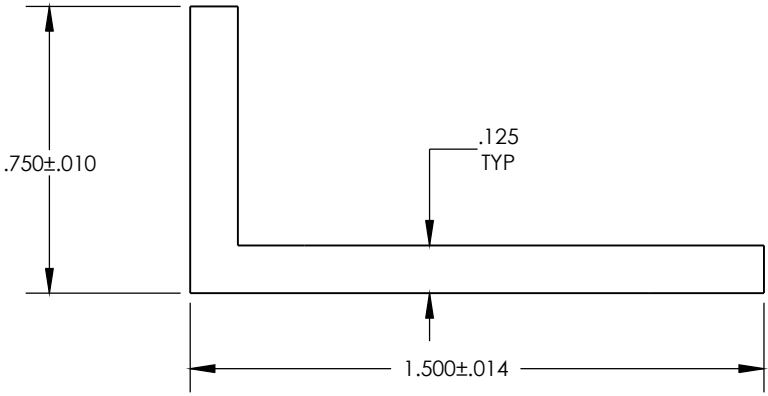

WALL THICKNESS .125 ± .008 EXCEPT AS SHOWN

DATE	REV	DESCRIPTION	BY
EST. AREA	.266	IN. ²	EST. AREA 171.613
EST. WT.	.311	LBS/FT.	EST. WT. .463
EST. PER.	4.500	IN.	EST. PER. 114.300
OUT PER.		IN.	OUT PER.
C.C.D.	1.677	IN.	C.C.D. 42.596
FACTOR 14.5	FINISH M/F	ALLOY & TEMP. 6005A	
CKD BY	SCALE 2:1	DWN BY B.A.	DATE 5/30/18

WOLVERINE

2100 MARKET STREET
DECATUR, AL 35816
800-633-3972

THIS DRAWING IS NOT NECESSARILY A COPY OF YOUR ORIGINAL. PLEASE APPROVE DIMENSIONS AND TOLERANCES INDICATED. WOLVERINE ASSUMES NO RESPONSIBILITY EITHER TECHNICAL OR LEGAL FOR HAVING THIS SHAPE MADE. THE CUSTOMER AGREES TO FULLY PROTECT WOLVERINE FROM CLAIMS OF OTHERS RESULTING FROM THIS SHAPE.

SIGNED: _____ DATE: _____
PRINT NAME: _____