

NOTE: BREAK ALL CORNERS WITH 0.015" (0.38 MM) RADIUS UNLESS OTHERWISE NOTED. STANDARD TOLERANCES TO APPLY UNLESS OTHERWISE SPECIFIED.

CUSTOMER PART No.	CUSTOMER WOLVERINE STD	WLV DIE No. WS10106	REV No. 0
DESCRIPTION 1/4" x 3" FLAT BAR		QUOTE No. 18-1085-4	PROPOSAL No. S-10274

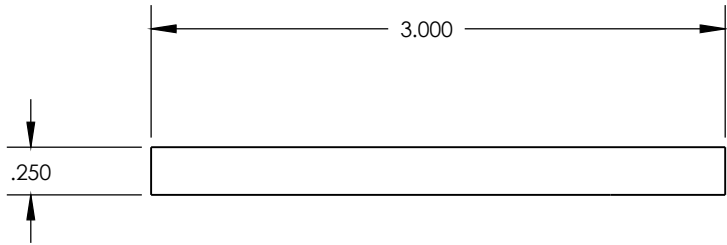

ACTUAL SIZE

WALL THICKNESS .250" EXCEPT AS SHOWN

DATE	REV	DESCRIPTION	BY
EST. AREA	.750	IN. ²	EST. AREA 483.87
EST. WT.	.878	LBS/FT.	EST. WT. 1.307
EST. PER.	6.500	IN.	EST. PER. 165.100
OUT PER.		IN.	OUT PER.
C.C.D.	3.010	IN.	C.C.D. 76.454
FACTOR 7.5	FINISH M/F	ALLOY & TEMP. 6061/6063	
CKD BY	SCALE 1:1	DWN BY B.A.	DATE 5/10/18

WOLVERINE

2100 MARKET STREET
DECATUR, AL 35816
800-633-3972

THIS DRAWING IS NOT NECESSARILY A COPY OF YOUR ORIGINAL. PLEASE APPROVE DIMENSIONS AND TOLERANCES INDICATED. WOLVERINE ASSUMES NO RESPONSIBILITY EITHER TECHNICAL OR LEGAL FOR HAVING THIS SHAPE MADE. THE CUSTOMER AGREES TO FULLY PROTECT WOLVERINE FROM CLAIMS OF OTHERS RESULTING FROM THIS SHAPE.

SIGNED: _____ DATE: _____
PRINT NAME: _____