

NOTE: BREAK ALL CORNERS WITH 0.015" (0.38 MM) RADIUS UNLESS OTHERWISE NOTED. STANDARD TOLERANCES TO APPLY UNLESS OTHERWISE SPECIFIED.

CUSTOMER PART No.	CUSTOMER WOLVERINE STD	WLV DIE No. WH10371	REV No. 0
DESCRIPTION 4" O.D. x 1/4" WALL TUBE		QUOTE No. 19-1134-2	PROPOSAL No. H-11321

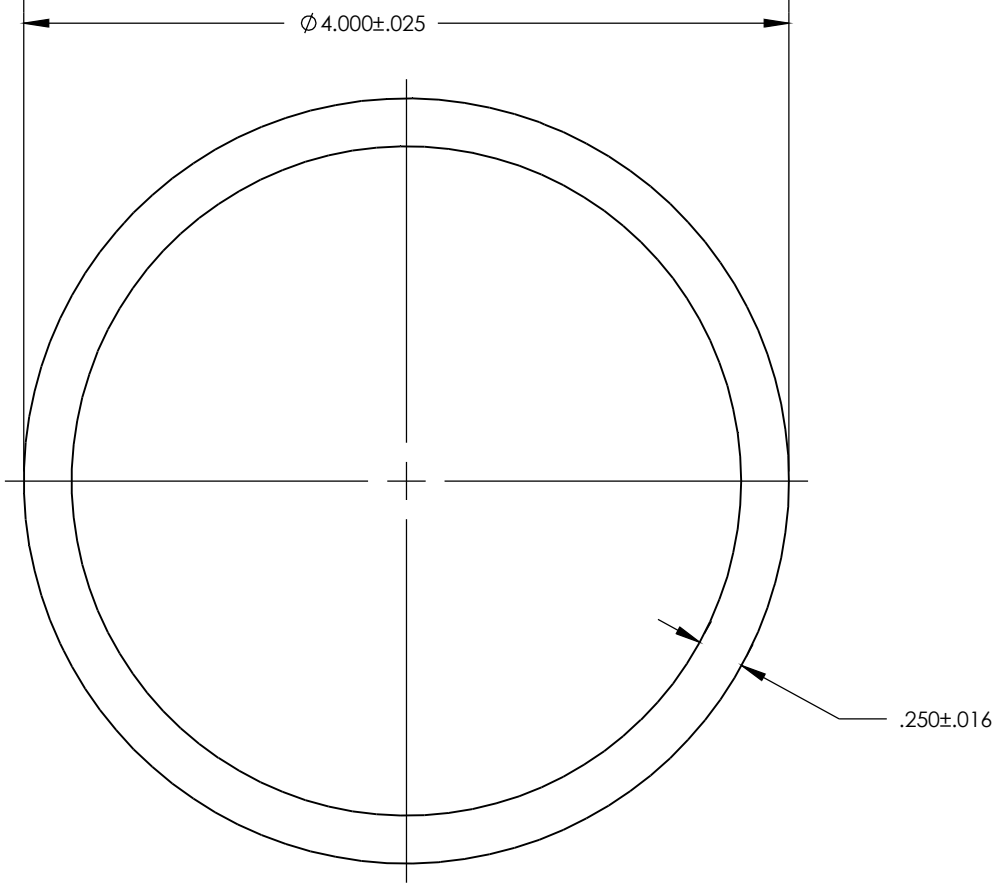

WALL THICKNESS .250 ± .016

DATE	REV	DESCRIPTION		BY	
EST. AREA	2.945	IN. ²	EST. AREA	1899.996	MM. ²
EST. WT.	3.447	LBS/FT.	EST. WT.	5.130	KG/M
EST. PER.	23.562	IN.	EST. PER.	598.475	MM.
OUT PER.	12.566	IN.	OUT PER.	319.176	MM.
C.C.D.	4.000	IN.	C.C.D.	101.600	MM.
FACTOR 7	FINISH	M/F	ALLOY & TEMP.	6061	
CKD BY	SCALE	1:1	DWN BY	B.A.	DATE 2/26/19

WOLVERINE

2100 MARKET STREET
DECATUR, AL 35816
800-633-3972

THIS DRAWING IS NOT NECESSARILY A COPY OF YOUR ORIGINAL. PLEASE APPROVE DIMENSIONS AND TOLERANCES INDICATED. WOLVERINE ASSUMES NO RESPONSIBILITY EITHER TECHNICAL OR LEGAL FOR HAVING THIS SHAPE MADE. THE CUSTOMER AGREES TO FULLY PROTECT WOLVERINE FROM CLAIMS OF OTHERS RESULTING FROM THIS SHAPE.

SIGNED: _____ DATE: _____
PRINT NAME: _____