

NOTE: BREAK ALL CORNERS WITH 0.015" (0.38 MM) RADIUS UNLESS OTHERWISE NOTED. STANDARD TOLERANCES TO APPLY UNLESS OTHERWISE SPECIFIED.

CUSTOMER PART No.	CUSTOMER <b>WOLVERINE STD</b>	WLV DIE No. <b>WH10144</b>	REV No. <b>0</b>
DESCRIPTION <b>2" SCHEDULE 80 PIPE</b>		QUOTE No. <b>18-1108-1</b>	PROPOSAL No. <b>H-10322</b>

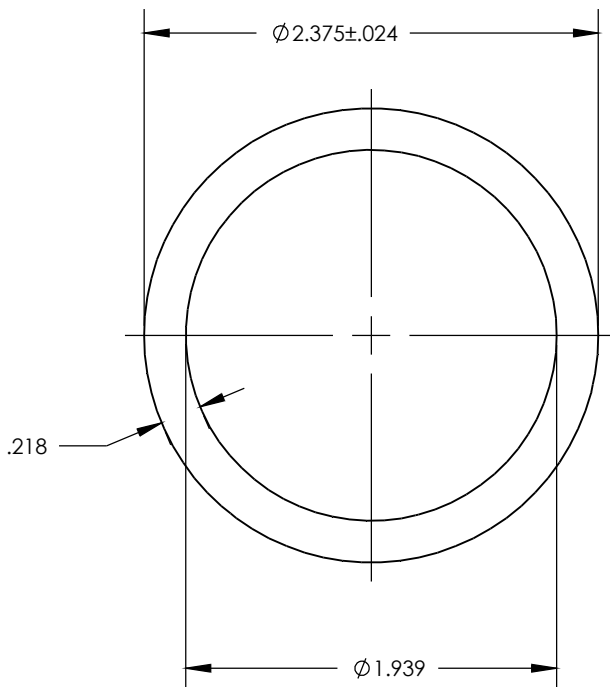

ACTUAL SIZE

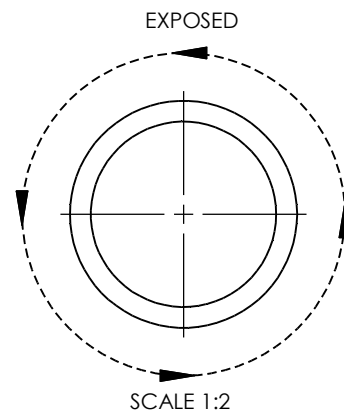

WALL THICKNESS .218" EXCEPT AS SHOWN

DATE	REV	DESCRIPTION	BY
EST. AREA	1.477	IN. <sup>2</sup>	EST. AREA 952.901
EST. WT.	1.729	LBS/FT.	EST. WT. 2.573
EST. PER.	13.553	IN.	EST. PER. 344.246
OUT PER.	7.461	IN.	OUT PER. 189.509
C.C.D.	2.375	IN.	C.C.D. 60.325
FACTOR 8	FINISH M/F	ALLOY & TEMP.	6061
CKD BY	SCALE 1:1	DWN BY <b>B.A.</b>	DATE 6/4/18

**WOLVERINE**

2100 MARKET STREET  
DECATUR, AL 35816  
800-633-3972

THIS DRAWING IS NOT NECESSARILY A COPY OF YOUR ORIGINAL. PLEASE APPROVE DIMENSIONS AND TOLERANCES INDICATED. WOLVERINE ASSUMES NO RESPONSIBILITY EITHER TECHNICAL OR LEGAL FOR HAVING THIS SHAPE MADE. THE CUSTOMER AGREES TO FULLY PROTECT WOLVERINE FROM CLAIMS OF OTHERS RESULTING FROM THIS SHAPE.

SIGNED: \_\_\_\_\_ DATE: \_\_\_\_\_  
PRINT NAME: \_\_\_\_\_