

NOTE: BREAK ALL CORNERS WITH 0.015" (0.38 MM) RADIUS UNLESS OTHERWISE NOTED. STANDARD TOLERANCES TO APPLY UNLESS OTHERWISE SPECIFIED.

CUSTOMER PART No.	CUSTOMER <b>WOLVERINE STD</b>	WLV DIE No. <b>WH10078</b>	REV No. <b>0</b>
DESCRIPTION <b>1.5" x .093 WALL ROUND TUBE</b>		QUOTE No. <b>18-1020-5</b>	PROPOSAL No. <b>H-10151</b>

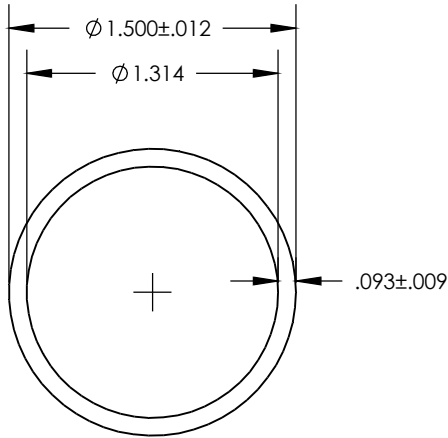

ACTUAL SIZE

WALL THICKNESS .093 ± .009 EXCEPT AS SHOWN

DATE	REV	DESCRIPTION		BY	
EST. AREA	.411	IN. <sup>2</sup>	EST. AREA	265.161	MM. <sup>2</sup>
EST. WT.	.481	LBS/FT.	EST. WT.	.716	KG/M
EST. PER.	8.840	IN.	EST. PER.	224.536	MM.
OUT PER.	4.712	IN.	OUT PER.	119.685	MM.
C.C.D.	1.500	IN.	C.C.D.	38.100	MM.
FACTOR	18.5	FINISH	M/F	ALLOY & TEMP.	6063
CKD BY		SCALE	1:1	DWN BY	<b>B.A.</b>
				DATE	2/27/18

**WOLVERINE**

2100 MARKET STREET  
DECATUR, AL 35816  
800-633-3972

THIS DRAWING IS NOT NECESSARILY A COPY OF YOUR ORIGINAL. PLEASE APPROVE DIMENSIONS AND TOLERANCES INDICATED. WOLVERINE ASSUMES NO RESPONSIBILITY EITHER TECHNICAL OR LEGAL FOR HAVING THIS SHAPE MADE. THE CUSTOMER AGREES TO FULLY PROTECT WOLVERINE FROM CLAIMS OF OTHERS RESULTING FROM THIS SHAPE.

SIGNED: \_\_\_\_\_ DATE: \_\_\_\_\_  
PRINT NAME: \_\_\_\_\_