

NOTE: BREAK ALL CORNERS WITH 0.015" (0.38 MM) RADIUS UNLESS OTHERWISE NOTED. STANDARD TOLERANCES TO APPLY UNLESS OTHERWISE SPECIFIED.

CUSTOMER PART No.	CUSTOMER <b>WOLVERINE STD</b>	WLV DIE No. <b>WH10077</b>	REV No. <b>0</b>
DESCRIPTION <b>3.5" x .188 WALL ROUND TUBE</b>		QUOTE No. <b>18-1018-1</b>	PROPOSAL No. <b>H-10145</b>

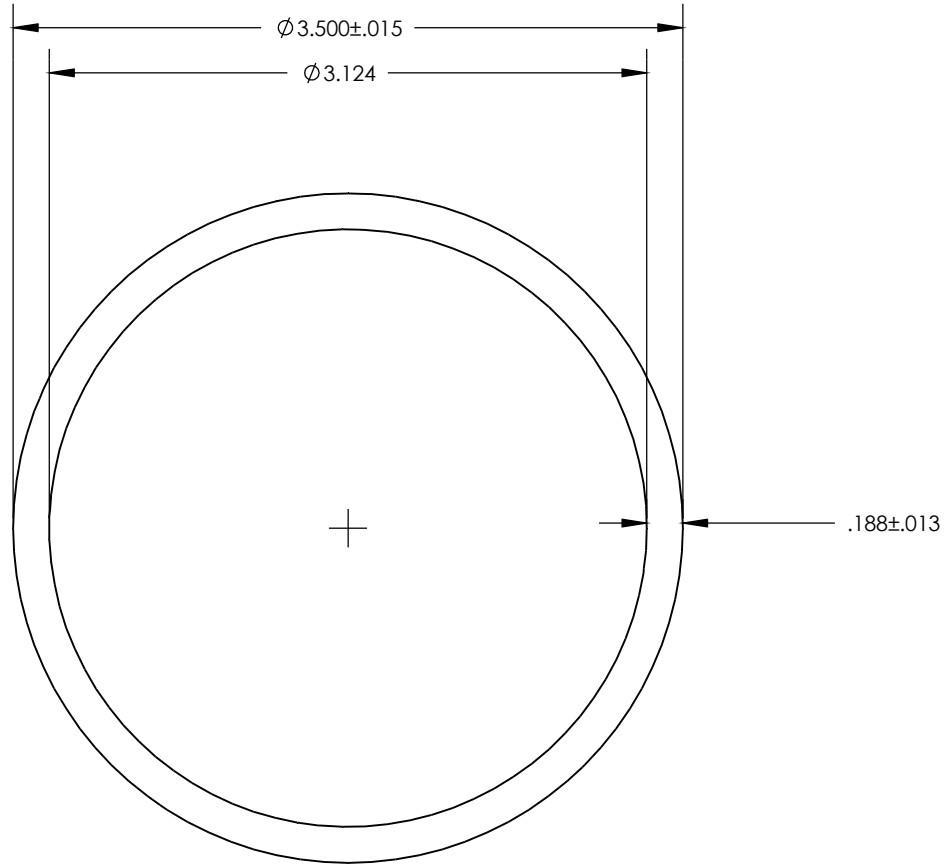

ACTUAL SIZE

WALL THICKNESS .188 ± .013 EXCEPT AS SHOWN

DATE	REV	DESCRIPTION	BY
EST. AREA	1.956	IN. <sup>2</sup>	EST. AREA 1261.933
EST. WT.	2.290	LBS/FT.	EST. WT. 3.408
EST. PER.	20.810	IN.	EST. PER. 528.574
OUT PER.	10.996	IN.	OUT PER. 279.298
C.C.D.	3.500	IN.	C.C.D. 88.900
FACTOR 9	FINISH M/F	ALLOY & TEMP. 6061	
CKD BY	SCALE 1:1	DWN BY <b>B.A.</b>	DATE 2/27/18

**WOLVERINE**

2100 MARKET STREET  
DECATUR, AL 35816  
800-633-3972

THIS DRAWING IS NOT NECESSARILY A COPY OF YOUR ORIGINAL. PLEASE APPROVE DIMENSIONS AND TOLERANCES INDICATED. WOLVERINE ASSUMES NO RESPONSIBILITY EITHER TECHNICAL OR LEGAL FOR HAVING THIS SHAPE MADE. THE CUSTOMER AGREES TO FULLY PROTECT WOLVERINE FROM CLAIMS OF OTHERS RESULTING FROM THIS SHAPE.

SIGNED: \_\_\_\_\_ DATE: \_\_\_\_\_  
PRINT NAME: \_\_\_\_\_